

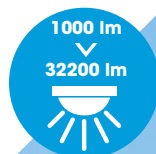

# ARO

- ▶ Flexible sleeve for lateral or top mounting.
- ▶ Available in 2 sizes.
- ▶ Smart City compatibility.



Zhaga  
standard



The ARO luminaire is composed of an aluminum body and a tempered glass finish. With its circular design adorned with raised grooves, it can be configured as a lateral or top mounting luminaire thanks to a flexible sleeve that can be tilted in 5° increments. It can be accompanied by optional accessories such as a dedicated console, equipped with a floodlight located at the rear, offering the possibility of creating a highlighting scenario. With its curved arm, the ARO lyre can also be added to bring harmony to the ensemble. Available in 2 sizes, it's the thinnest luminaire in our range. Electrical class I or II, ARO accommodates from 8 to 80 LEDs to provide high performance asymmetric road lighting. An integrated heatsink ensures efficient thermal regulation of the luminaire. Compatible with Zhaga standards and meeting the requirements of smart cities, it is IP66 rated, and its shock energy is IK09.

02/28/2022-All informations are subject to change without notice.

# ARO

ROAD | ARO

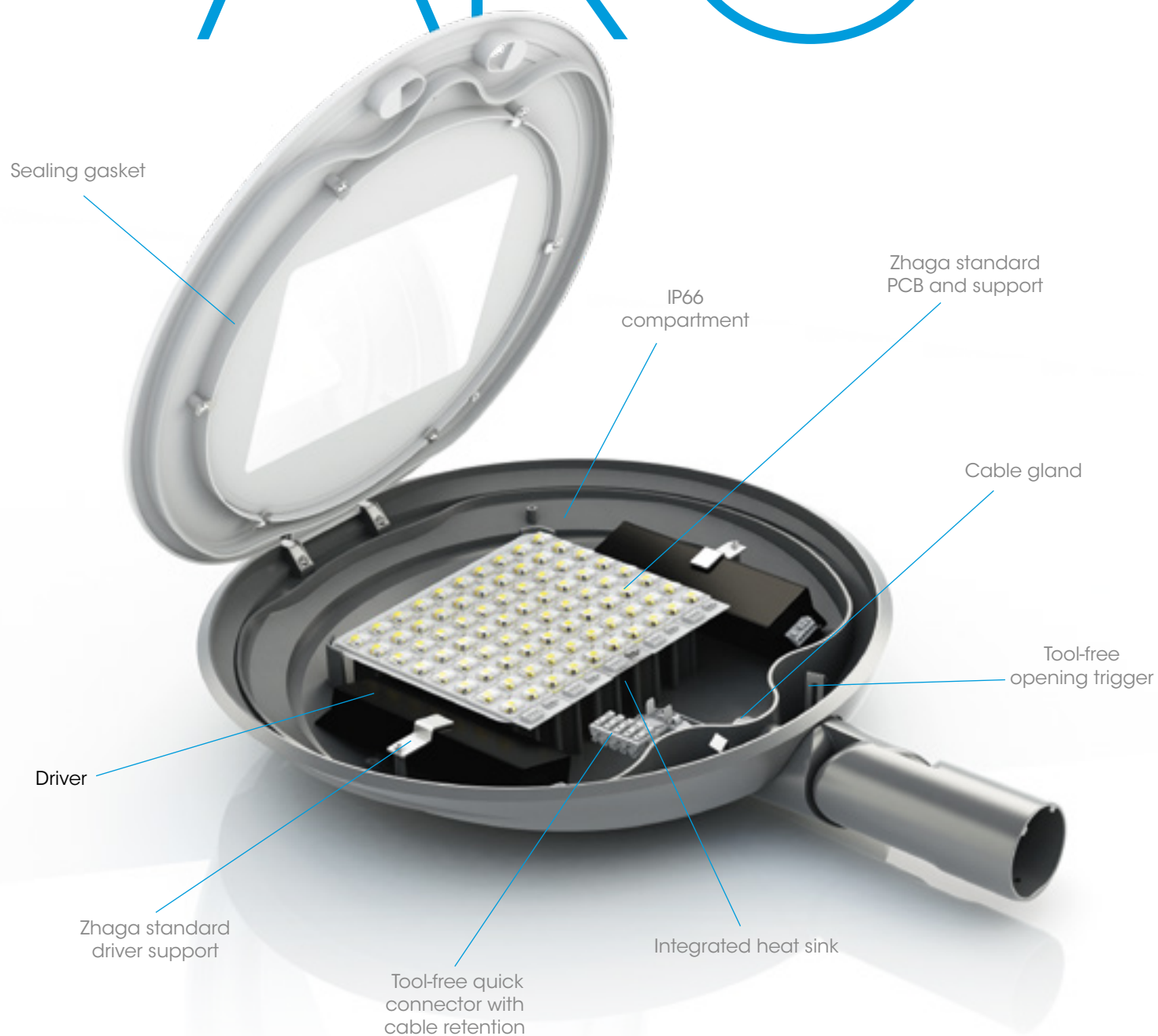

02/28/2022- All informations are subject to change without notice.



# VARIATIONS & ACCESSORIES

Flexible sleeve with adjustable notched ball joint from 5° to 5° for installation on any type of console Ø34\* Ø42\* Ø48\* Ø60 or on top mounting. Ideal for retrofitting on very inclined bracket.

/With optional reducing wedge

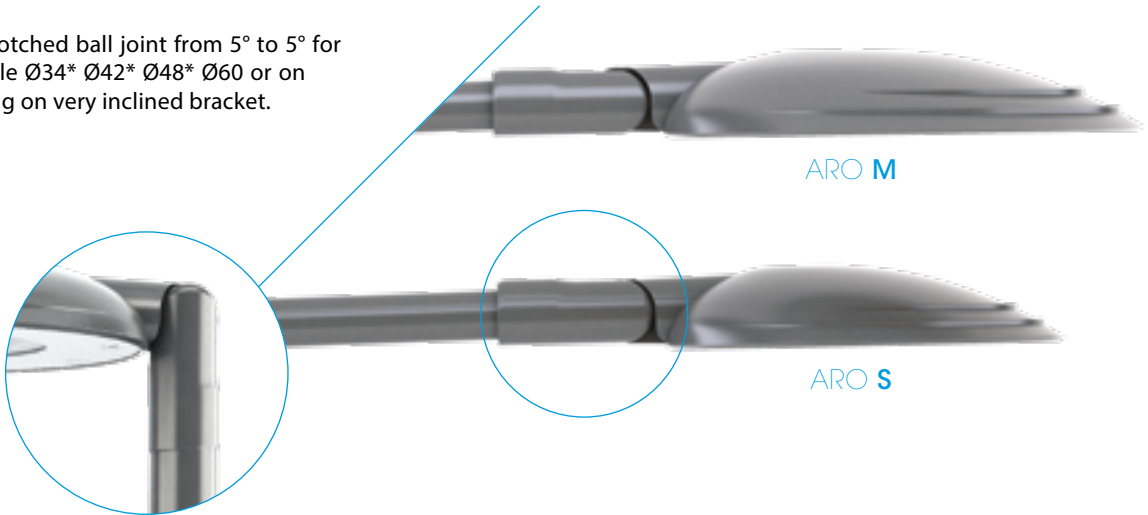

ARO M

ARO S

## ARO bracket



Optional integration of a floodlight at the back of the bracket to create a highlighting scenario.

Optional decorative tip



## ARO yoke

Aesthetic yoke in harmony with the design of the ARO S or M luminaire.



02/28/2022- All informations are subject to change without notice.

# ARO S

## LUMINAIRE'S SPECIFICATIONS

### Luminaire's body

Weight	21 lbs
EPA	0.30
Protection index	IP66
Materials	Aluminium

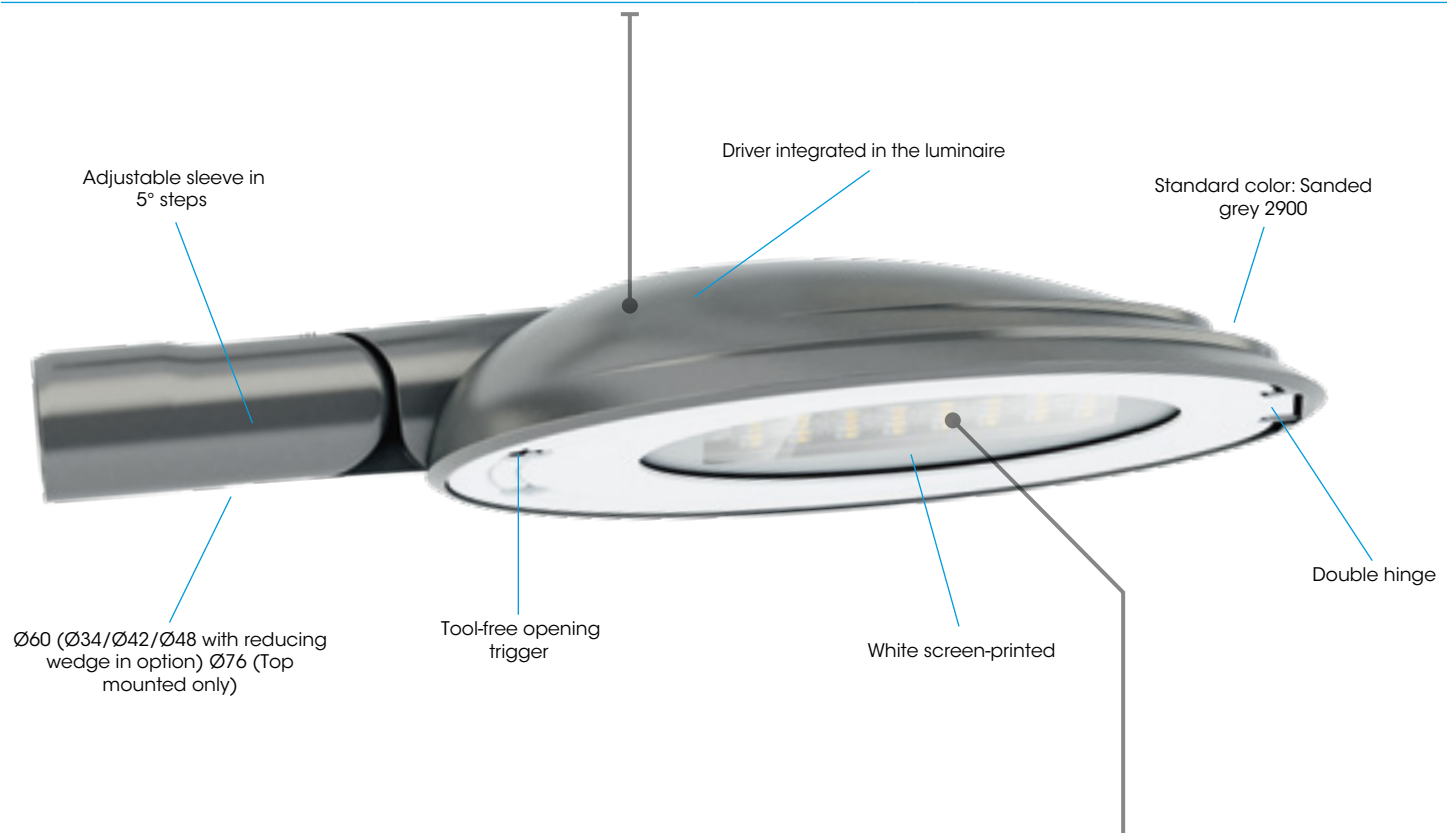

### Optical unit & control gear

8 to 48 LED PCB in Zhaga standard - From 1000 to 19300 lm (see attached Aro datasheet for details on power, light intensity and photometry available). Integrated smart driver (control, automatic adjustment, CLO, graduation via voltage variation, DALI or Zhaga D4i). ULR 0% (LED) (ULR: Upward Light Ratio).

Materials	Tempered glass
Electric class	I and II
Protection index	IP66
Shock resistance	IK09

Operating temperature: -13°F to +95°F (up to +50° under conditions).

02/28/2022 - All informations are subject to change without notice.

## Dimensions (in)

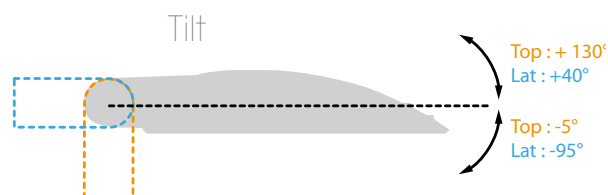
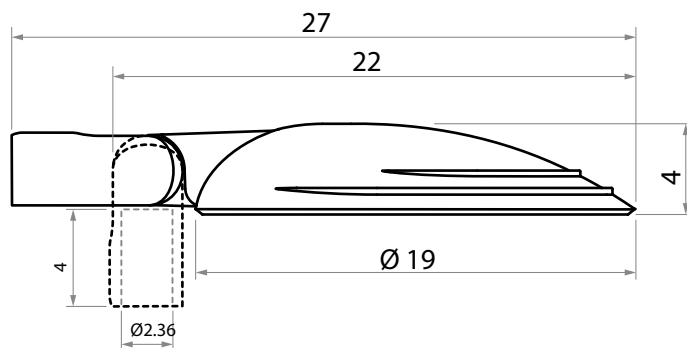

**Installation note:**  
Tilts are possible to adapt the luminaire to different bracket configurations. In order to comply with light pollution control requirements, the inclination of a luminaire should not exceed 20°.

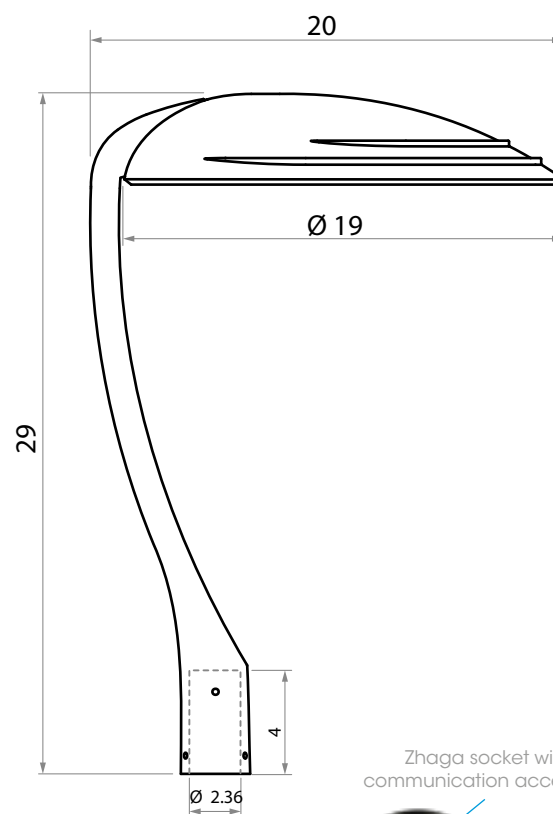

## Options

- Pre-wiring.
- Surge protector.
- Zhaga socket or Nema socket on the top and/or bottom of the luminaire + smart lighting accessories (detection, communication, photocell, sensors...).
- Ø34/42/48 with reducing wedge, Ø76 top mounted.
- Backlight control..
- Automatic disconnection when the luminaire is opened.
- NTC sensor.



## Ecodesign

Luminaire designed in compliance with the environmental criteria of energy efficiency, recyclability and interoperability.

Associate member of the Zhaga consortium, Ragni integrates electronic elements in this product that comply with the Zhaga standard, which ensures its scalability and interoperability. This luminaire is Zhaga D4i certified.

Member of the Global Compact since 2018, Ragni is committed to working towards the 17 Sustainable Development Goals (SDG 11, 12, 13, 15).

Luminaire guaranteed free of hazardous substances.

reduction and limitation of light pollution: product configuration to be defined according to the nature of the project.

# ARO M

## LUMINAIRE'S SPECIFICATIONS

### Luminaire's body

Weight	28 lbs
EPA	0.33
Protection index	IP66
Materials	Aluminium

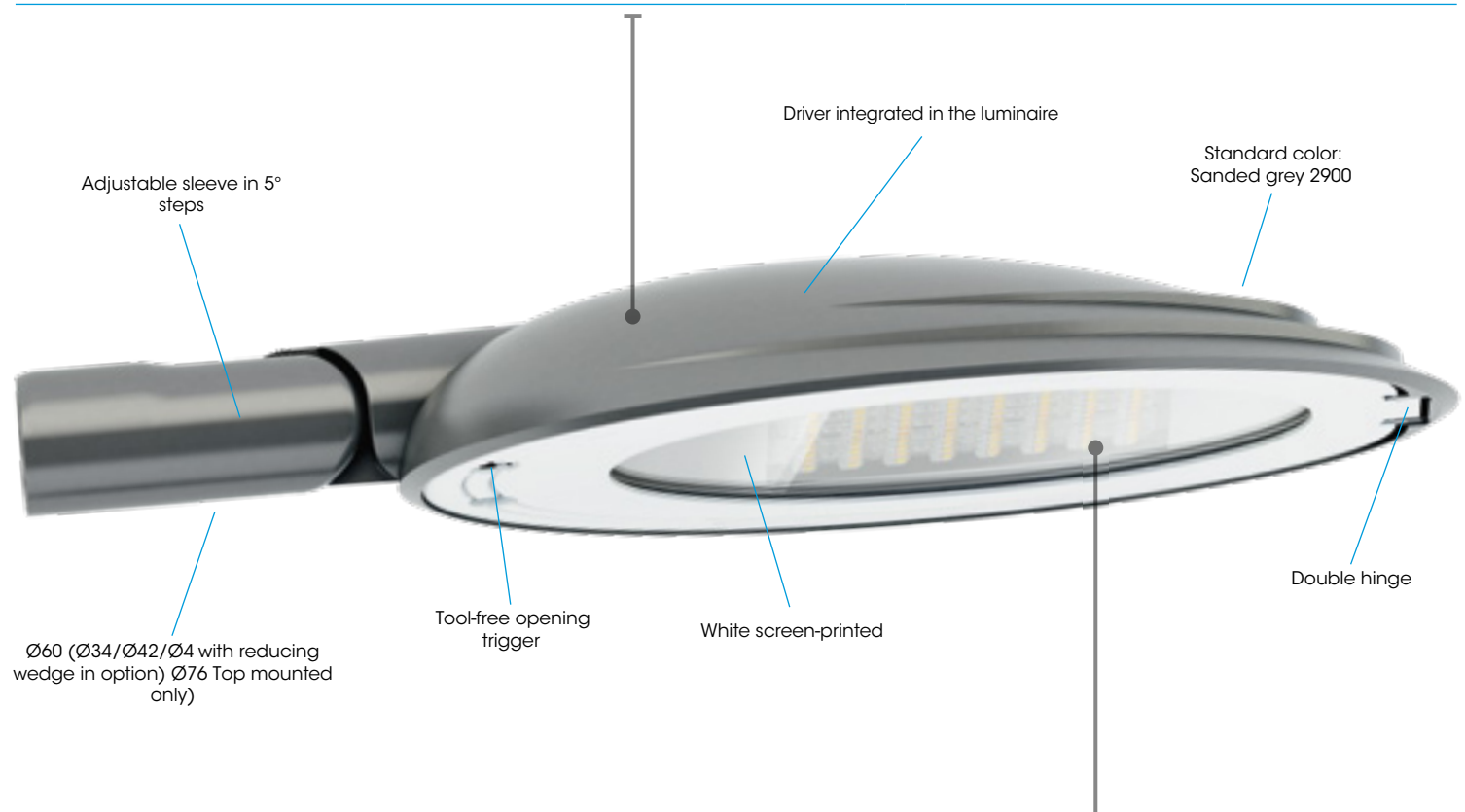

### Optical unit & control gear

32 to 80 LED PCB in Zhaga standard - From 3100 to 32200 lm (see attached Aro datasheet for details on power, light intensity and photometry available). Integrated smart driver (control, automatic adjustment, CLO, graduation via voltage variation, DALI or Zhaga D4i). ULR 0% (LED) (ULR: Upward Light Ratio).

Materials	Tempered glass
Electric class	I and II
Protection index	IP66
Shock resistance	IK09

Operating temperature: -13°F to +95°F (up to +50° under conditions).

02/28/2022 - All informations are subject to change without notice.

## Dimensions (in)

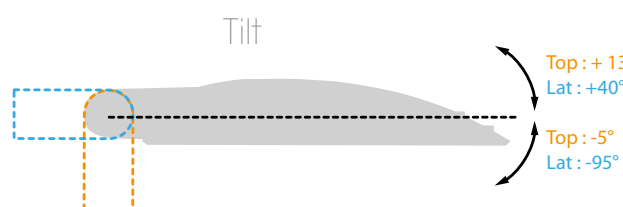
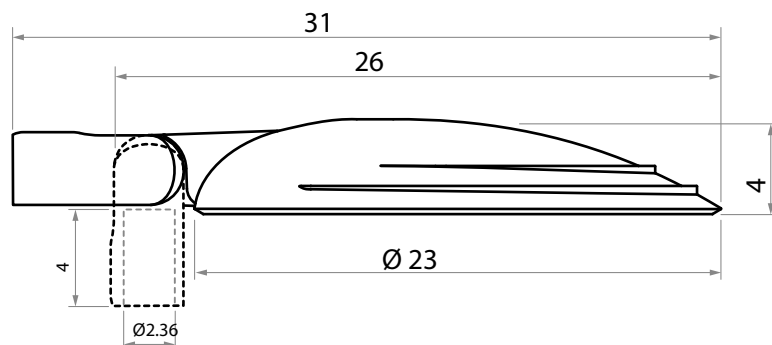

**Installation note:**  
Tilts are possible to adapt the luminaire to different bracket configurations. In order to comply with light pollution control requirements, the inclination of a luminaire should not exceed 20°.

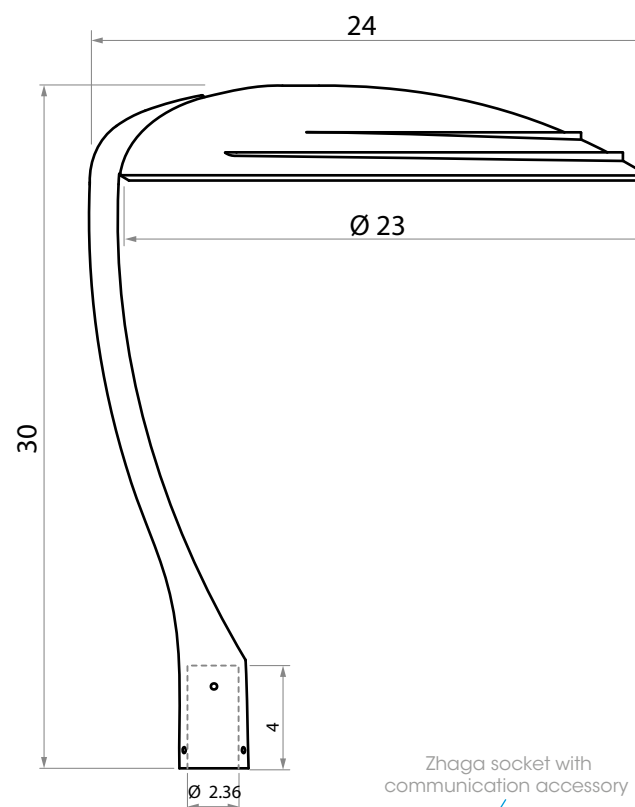

## Options

- Pre-wiring
- Surge protector.
- Zhaga socket or Nema socket on the top and/or bottom of the luminaire + smart lighting accessories (detection, communication, photocell, sensors...).
- Ø34/42/48 with reducing wedge, Ø76 top mounted.
- Backlight control.
- Automatic disconnection when the luminaire is opened.
- NTC sensor.

## Ecodesign

Luminaire designed in compliance with the environmental criteria of energy efficiency, recyclability and interoperability.

Associate member of the Zhaga consortium, Ragni integrates electronic elements in this product that comply with the Zhaga standard, which ensures its scalability and interoperability. This luminaire is Zhaga D4i certified.

Member of the Global Compact since 2018, Ragni is committed to working towards the 17 Sustainable Development Goals (SDG 11, 12, 13, 15).

Luminaire guaranteed free of hazardous substances.

reduction and limitation of light pollution: product configuration to be defined according to the nature of the project.

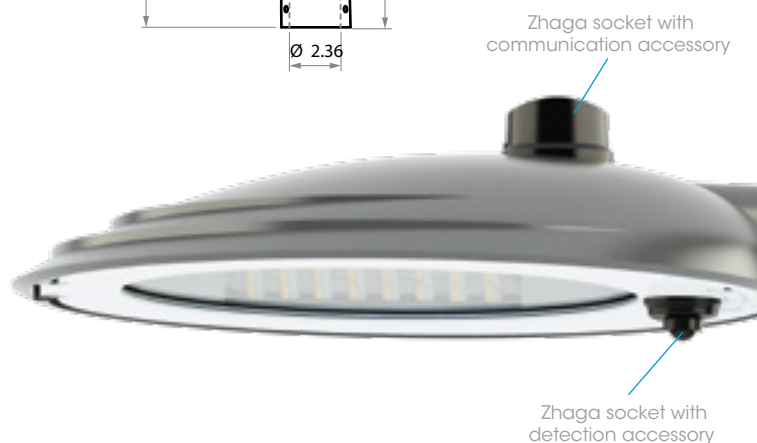



POWERS AND LUMINOUS INTENSITIES - LUMINAIRE OUTPUT DATA

			3000 K Number of LED	350 mA			500 mA			700 mA		
				P <sub>t</sub> (W)	Φ (lm)	(lm/W)	P <sub>t</sub> (W)	Φ (lm)	(lm/W)	P <sub>t</sub> (W)	Φ (lm)	(lm/W)
ARO M	ARO S	8	10	1187	119	14	1626	117	19	2181	115	
		12	15	1779	119	20	2444	123	27	3271	122	
		16	19	2375	125	26	3257	126	36	4361	122	
		24	27	3557	132	38	4888	129	52	6542	126	
		32	35	4749	136	49	6514	133	69	8723	127	
		48	51	7124	140	73	9771	134	103	13084	128	
	64		68	9499	140	96	13028	136	136	17445	128	
	80		84	11873	142	120	16286	136	172	21806	127	

			4000 K Number of LED	350 mA			500 mA			700 mA		
				P <sub>t</sub> (W)	Φ (lm)	(lm/W)	P <sub>t</sub> (W)	Φ (lm)	(lm/W)	P <sub>t</sub> (W)	Φ (lm)	(lm/W)
ARO M	ARO S	8	10	1252	126	14	1719	123	19	2301	122	
		12	15	1880	126	20	2578	129	27	3451	128	
		16	19	2504	132	26	3437	133	36	4602	128	
		24	27	3761	140	38	5156	136	52	6902	133	
		32	35	5008	144	49	6875	141	69	9203	134	
		48	51	7512	148	73	10312	142	103	13805	135	
	64		68	10016	148	96	13749	144	136	18406	136	
	80		84	12520	150	120	17186	144	172	23008	134	

Luminaire output data (real operating values, including optical losses)

P<sub>t</sub> (W) = Total power consumption including driver consumption • Φ (Nominal flux (lm) • Luminous efficiency (lm/W)

ORDERING INFORMATION

Model	Size	# LED	Drive Current (mA)	CCT (K)	Distribution	Line Voltage	Mounting	Color
ARO	S*	8	35-(350)	3-(3000)	T1	1-(120-277)	TP-(Top)	BLK-(Black)
	M*	12	50-(500)	4-(4000)	T2	3-(347-480)	LT-(Lateral)	BRZ-(Bronze)
		16	70-(700)		T3			SLV-(Sliver)
		24	C-(Custom)		T4			WHT-(White)
		32			T5			(RAL #)
		48						
		64						
		80						

\*ARO S Available with 8-48 LED's & ARO M Available with 32-80 LED's





# Sets proposals

- **Standard color:** Sanded grey 2900.
- **Option:** other colors on request.



ROAD | ARO

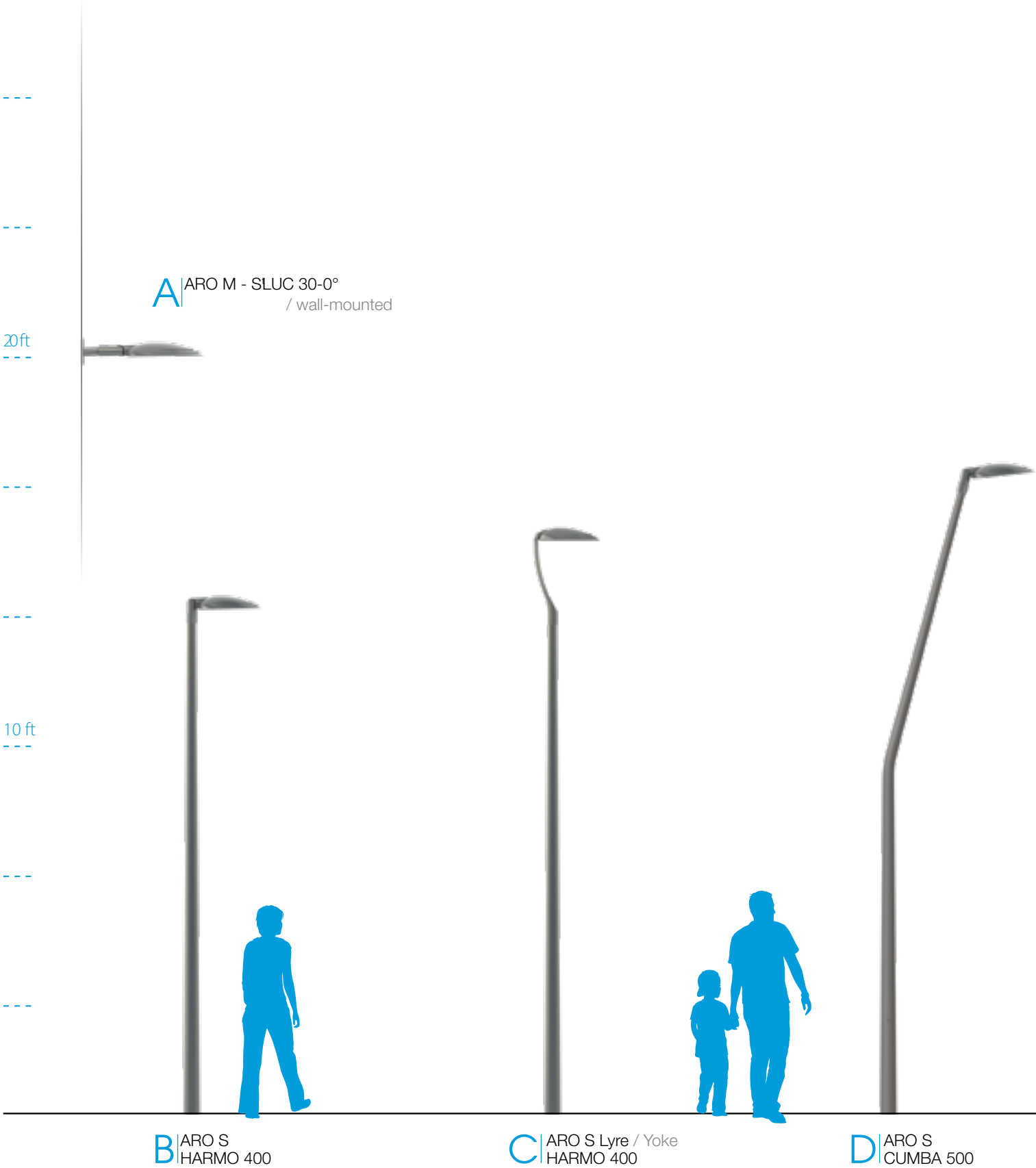

# ARO

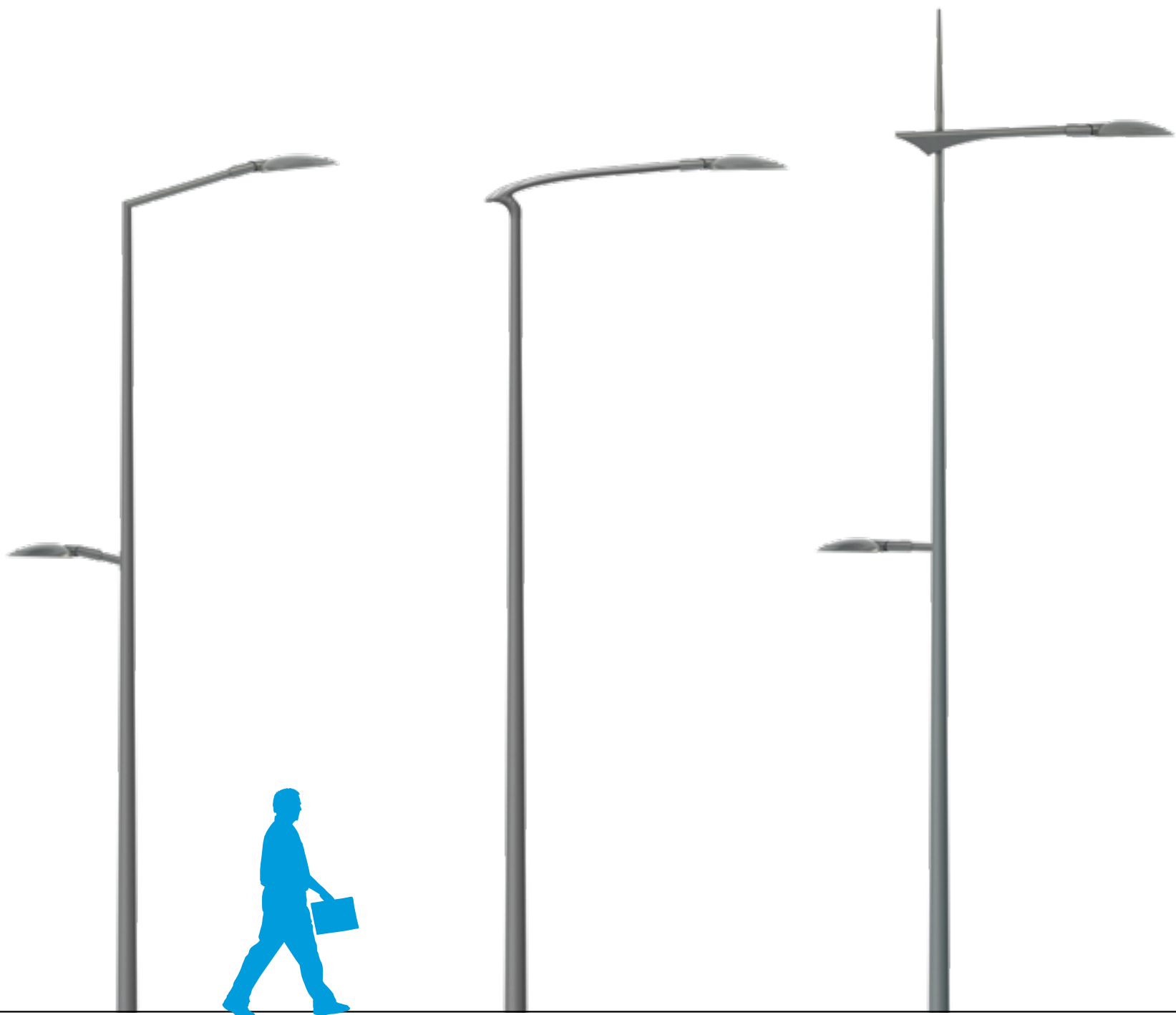

**E** | ARO M - ARO S  
TURIN 100 15° - S' LUC 30-15°  
JIMA 600

**F** | ARO M  
EXIS 120 - JAVA 600

**G** | ARO M - ARO S  
Console / Bracket ARO - S' LUC 30-5°  
JIMA 650 - Pointe decorative 600  
/ Decorative tip 600