

AIR



IK09
IP66



980 lm
3800 lm



Zhaga
standard





- ▶ **Double access door.**
- ▶ **White or black diffuser according to the photometric needs.**
- ▶ **Backlit or painted door (optional).**

The AIR bollard is composed of a cap containing the driver, an IK09 polycarbonate bowl treated against UV and a white or black diffuser according to the photometric needs. It has an aluminum body with a face made of a combination of sharp edges and a large chamfer. The door is painted in a color of your choice or backlit (optional). The rectangular section is 46 inches high and has an IP66 waterproof rating. Ideally designed for pathways, Air houses 8 or 16 LEDs and allows, via its color temperatures and photometrics, to precisely meet the lighting needs of the project while ensuring compliance with the regulations against light pollution.

Regulation specific to France: Decree of 27/12/2018 relating to the prevention, reduction and limitation of light nuisance: product configuration to be defined according to the nature of the project.

02/21/2022- All informations are subject to change without notice.

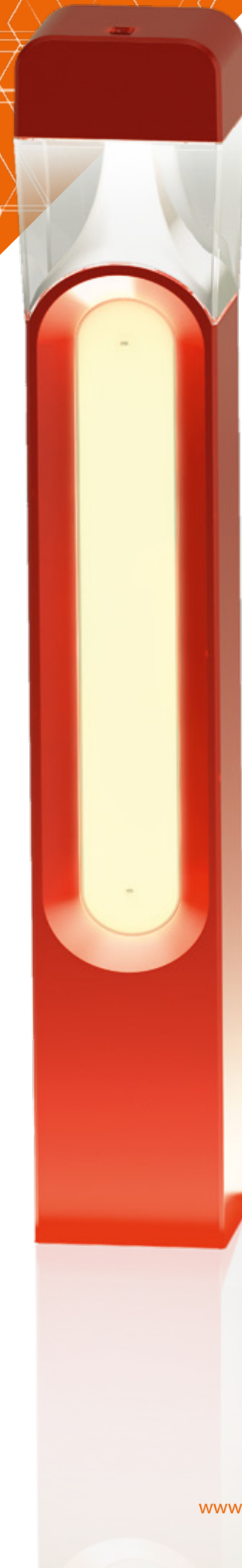

AIR

BOLLARD'S SPECIFICATIONS

Bollard's body & control gear

Weight	31 lbs
Materials	Aluminum

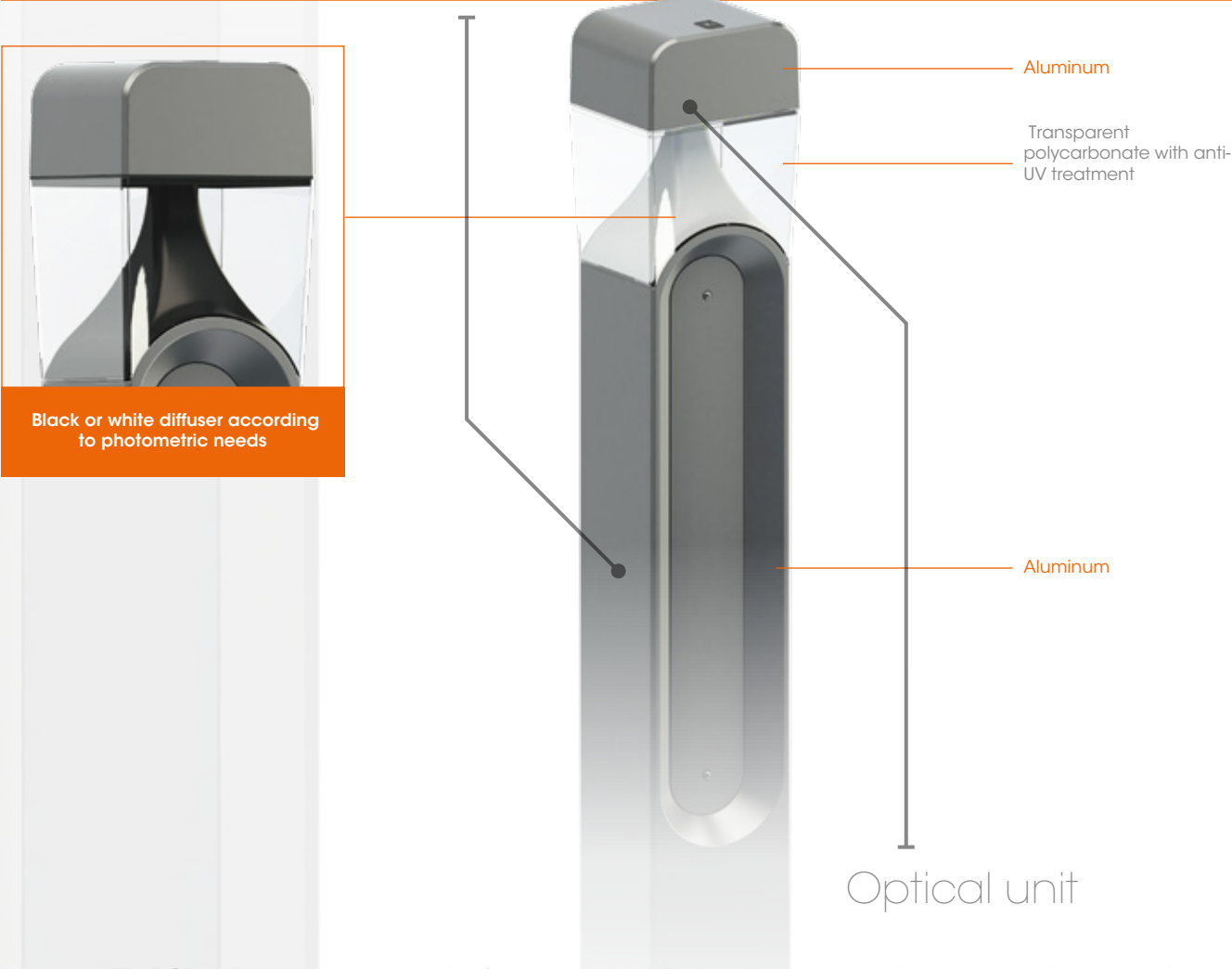

8 or 16 LED PCB - From 980 to 3800 lm (see attached AIR datasheet for details on power, light intensity and photometry available). Integrated smart driver (control, automatic adjustment, CLO, graduation via voltage variation or DALI). ULR < 1% (ULR: Upward Light Ratio).

Materials	Anti-UV treated polycarbonate
Electric class	I and II
Protection index	IP66
Shock resistance	IK09

Operating temperature: -13°F to +95°F (up to +50° under conditions).

"S S S S" All informations are subject to change without notice.

Dimensions (in)

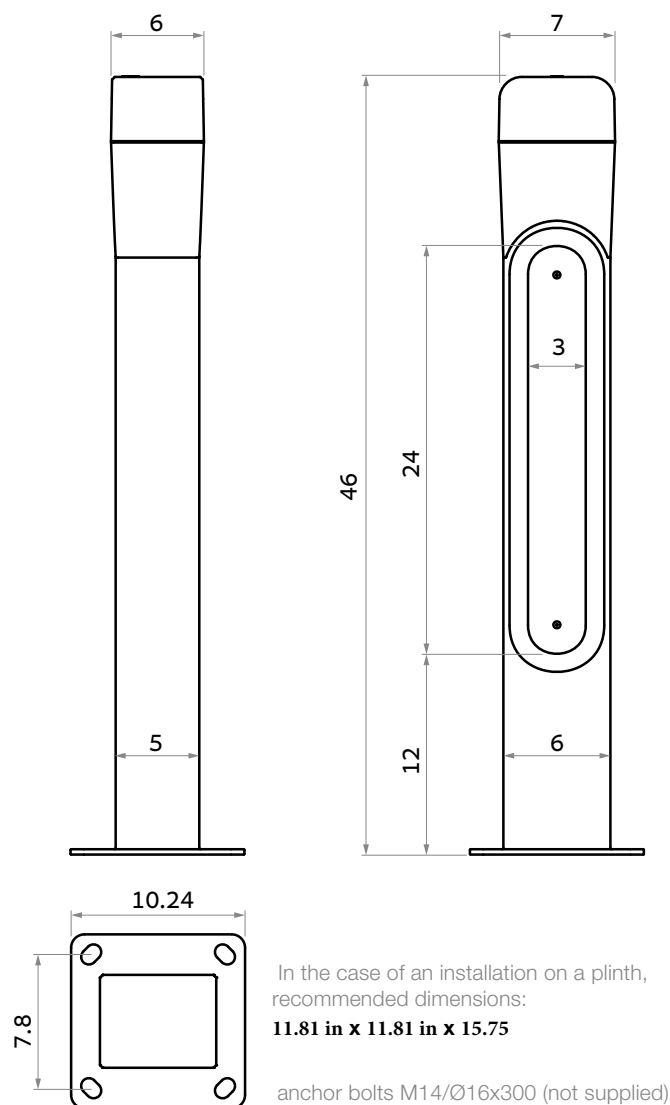

Options



- Backlit door.
- Surge protector.
- NTC sensor.
- Presence detector.

Eco-design

Luminaire designed in compliance with the environmental criteria of energy efficiency, recyclability and interoperability.

Associate member of the Zhaga consortium, Ragni integrates elec-tronic elements in this product that comply with the Zhaga standard, which ensures its scalability and interoperability.

Member of the Global Compact since 2018, Ragni is committed to wor-king towards the 17 Sustainable Development Goals (SDG 11, 12, 13, 15).

Luminaire guaranteed free of hazardous substances.

Luminaire eligible for the energy savings certificate.

Luminaire compliant with the decree of 27/12/2018 on the prevention, reduction and limitation of light pollution: product configuration to be defined according to the nature of the project.

Powers and luminous intensities

LUMINAIRE OUTPUT DATA

3000 K	350 mA			500 mA			700 mA		
	P _t (W)	Φ (lm)	(lm/W)	P _t (W)	Φ (lm)	(lm/W)	P _t (W)	Φ (lm)	(lm/W)
8	10	989	99	14	1355	97	19	1817	96
16	19	1979	105	26	2710	105	36	3634	101

4000 K	350 mA			500 mA			700 mA		
	P _t (W)	Φ (lm)	(lm/W)	P _t (W)	Φ (lm)	(lm/W)	P _t (W)	Φ (lm)	(lm/W)
8	10	1043	105	14	1432	103	19	1917	101
16	19	2087	110	26	2864	111	36	3634	107

P_t (W) = Total power consumption including driver
consumption Nominal flux (lm)
Luminous efficiency (lm/W)

Ordering Information

Fixture	# LED	Size	CCT	Drive Current	Distribution	Line Voltage	Head Color	Pole Color	Door Color	Diffuser Color
AIR	8	S - (46")	3 - (3000K)	35- (350 mA)	T3	1-(120-277	BLK-(Black)	BLK-(Black)	BLK-(Black)	BLK-(Black)
	16		4 - (4000K)	50 - (500 mA)	T5	3-(347-480	BRZ-(Bronze)	BRZ-(Bronze)	BRZ-(Bronze)	WHT-(White)
				70 - (700 mA)			SLV-(Silver)	SLV-(Silver)	SLV-(Silver)	
				C-(Custom)			WHT-(White)	WHT-(White)	WHT-(White)	
							RAL #	RAL #	RAL #	
									B-(Backlit)	

