



## ATINIA SLIM

FUNCTIONAL LIGHTING RANGE - STREET LIGHTING



### TECHNICAL CHARACTERISTICS

	ATINIA SLIM 6480	ATINIA SLIM 6600
<b>Weight (lbs)</b> <i>Without control gear</i>	13.22	26.46
<b>EPA (ft²)</b>	0.43	0.65
<b>Protection index</b>	IP66	IP66
<b>Shock resistance</b>	IK 08 (IK 10 optional)	IK 08 (IK 10 optional)
<b>Materials:</b>		
Luminaire		Injected cast aluminium
Top mounted version's connector		Cast aluminium
Protection		Tempered glass

### ELECTRICAL CHARACTERISTICS

- Power current up to 700mA
- Electrical class: I & II (PCB available only for Type II)
- Nominal voltage: 110-277V • 347-480V
- Varistor (protection against higher voltages)
- Optional surge protector or over/under voltage protection systems
- Driver integrated into the luminaire
- Optional lighting management systems

### LIGHTING DISTRIBUTIONS

- Type I
- Type II
- Type III
- Type IV
- Type V

All information is subject to change without notice

Update: 04/14/2021

[www.ragni-lighting.com](http://www.ragni-lighting.com)



[www.ragni-lighting.com](http://www.ragni-lighting.com)







**DIMENSIONS (In)**

	A	B	C	D	E
6480	18.9	3.4	23.0	8.7	23.2
6600	23.6	5.1	27.8	9.4	27.9

Side mounted

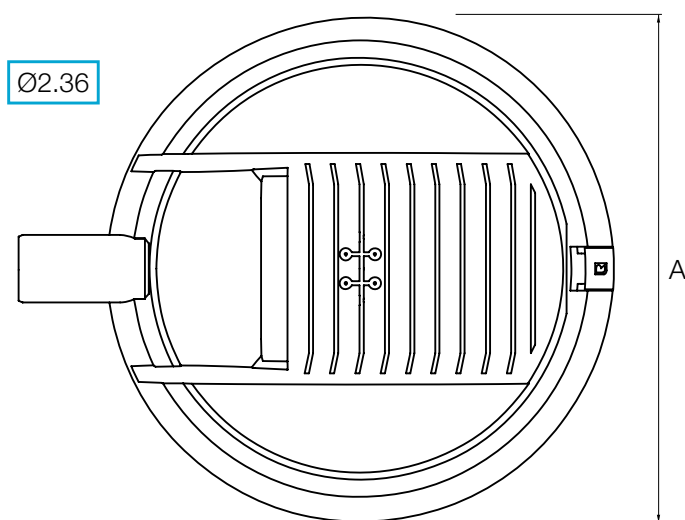

Suspended (only 6600)

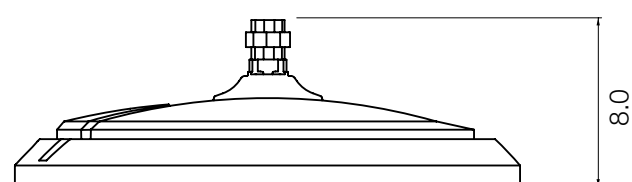

Top mounted

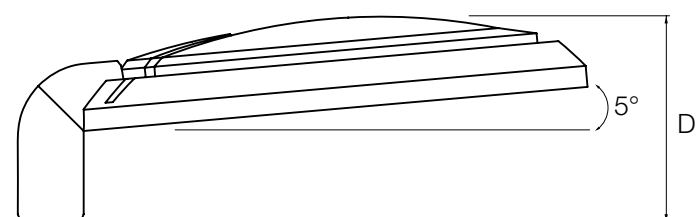

Side mounted

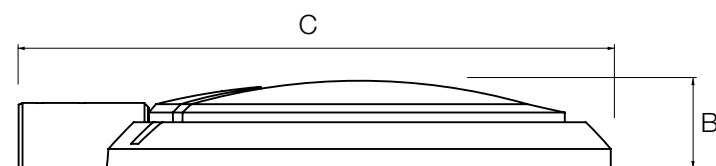

For flat bracket

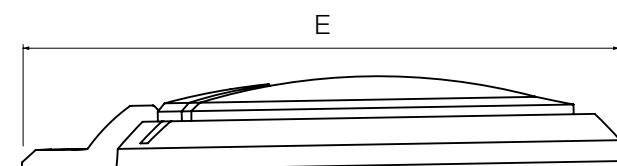

**THERMAL MANAGEMENT**

A heat-conducting pad applied between the PCB and the body as well as an integrated heat sink optimize the thermal control of the luminaires.



**LED PCB**

The LED PCB developed for the Atinia Slim 6480 and 6600 luminaires ensures powerful and precise lighting. Their modularity allows for the adaptation to specifications offering numerous photometric possibilities.

**ATINIA SLIM 6480**

- LED manufacturer: CREE
- LED's life cycle: up to 100 000 hours. i.e.: 60 000 hours at 85% @ 500 mA
- Color temperature: 3000K (4000K on request)
- CRI above 70

**ATINIA SLIM 6600**

- LED manufacturer: NICHIA
- LED's life cycle: up to 95 000 hours. i.e.: 50 000 hours at 70% @ 700 mA
- Color temperatures: 3000K or 4000K (other color temperatures on request)
- CRI: 80

**POWERS AND LUMINOUS INTENSITIES - LUMINAIRE OUTPUT DATA**

	3000 K	350 mA			500 mA			700 mA			1050 mA			
		Number of LED	P <sub>t</sub> (W)	Φ (lm)	(lm/W)	P <sub>t</sub> (W)	Φ (lm)	(lm/W)	P <sub>t</sub> (W)	Φ (lm)	(lm/W)	P <sub>t</sub> (W)	Φ (lm)	(lm/W)
<b>ATINIA SLIM 6600</b>	<b>6480</b>	16	21.4	1988	93	28.2	2867	102	36	3636	101	54.6	4895	90
		32	34.4	3976	116	48.8	5734	118	68.9	7271	106			
		48	51	5964	117	72.6	8601	118	102.3	10907	107			
		64	67.1	7952	119	95.6	11468	120	135.2	14542	108			
		80	85.5	10095	118	123	14425	117	175	18957	108			

	4000 K	350 mA			500 mA			700 mA			1050 mA			
		Number of LED	P <sub>t</sub> (W)	Φ (lm)	(lm/W)	P <sub>t</sub> (W)	Φ (lm)	(lm/W)	P <sub>t</sub> (W)	Φ (lm)	(lm/W)	P <sub>t</sub> (W)	Φ (lm)	(lm/W)
<b>ATINIA SLIM 6600</b>	<b>6480</b>	16	21.4	2147	100	28.2	3097	110	36	3932	109	54.6	5301	97
		32	34.4	4294	125	48.8	6193	127	68.9	7863	114			
		48	51	6441	126	72.6	9290	128	102.3	11795	115			
		64	67.1	8588	128	96.5	12387	130	135.2	15726	116			
		80	85.5	11490	134	123	15595	127	175	20515	117			

Luminaire output data (real operating values, including optical losses)

P<sub>t</sub> (W) = Total power consumption including driver consumption • ΦNominal flux (lm) • Luminous efficiency (lm/W)



**ORDERING INFORMATION**

Model	Size	# LED	Drive Current (mA)	CCT (K)	Distribution	Line Voltage	Mounting	Color Body
ATNS	6480*	16	35 – (350 mA)	3 - (3000K)	T1	1-(120- 277)	TP - (Top)	BLK – (Black)
	6600	32	50 – (500 mA)	4 - (4000K)	T2	3-(347- 480)	LT - (Lateral)	BRZ – (Bronze)
		48	70 – (700 mA)		T3		SUS - (Suspended)	SLV – (Silver)
		64	C - (Custom)		T4		FT - (Flat)	WHT – (White)
		80			T5			(RAL #)

\*6480 only available with 16, 32 or 48 LEDs.



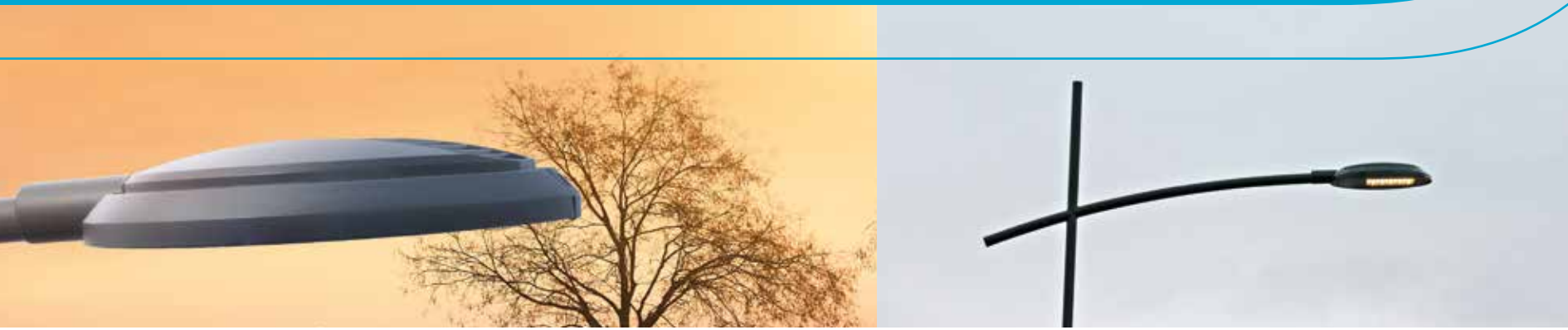

POLE, ARM & LUMINAIRE COMBINATIONS



6600  
Suspended or  
Catenary

ATINIA SLIM  
Top mounted

For flat bracket

6600  
6480

ATINIA SLIM  
Side mounted

A - CYNIS  
wall mounted

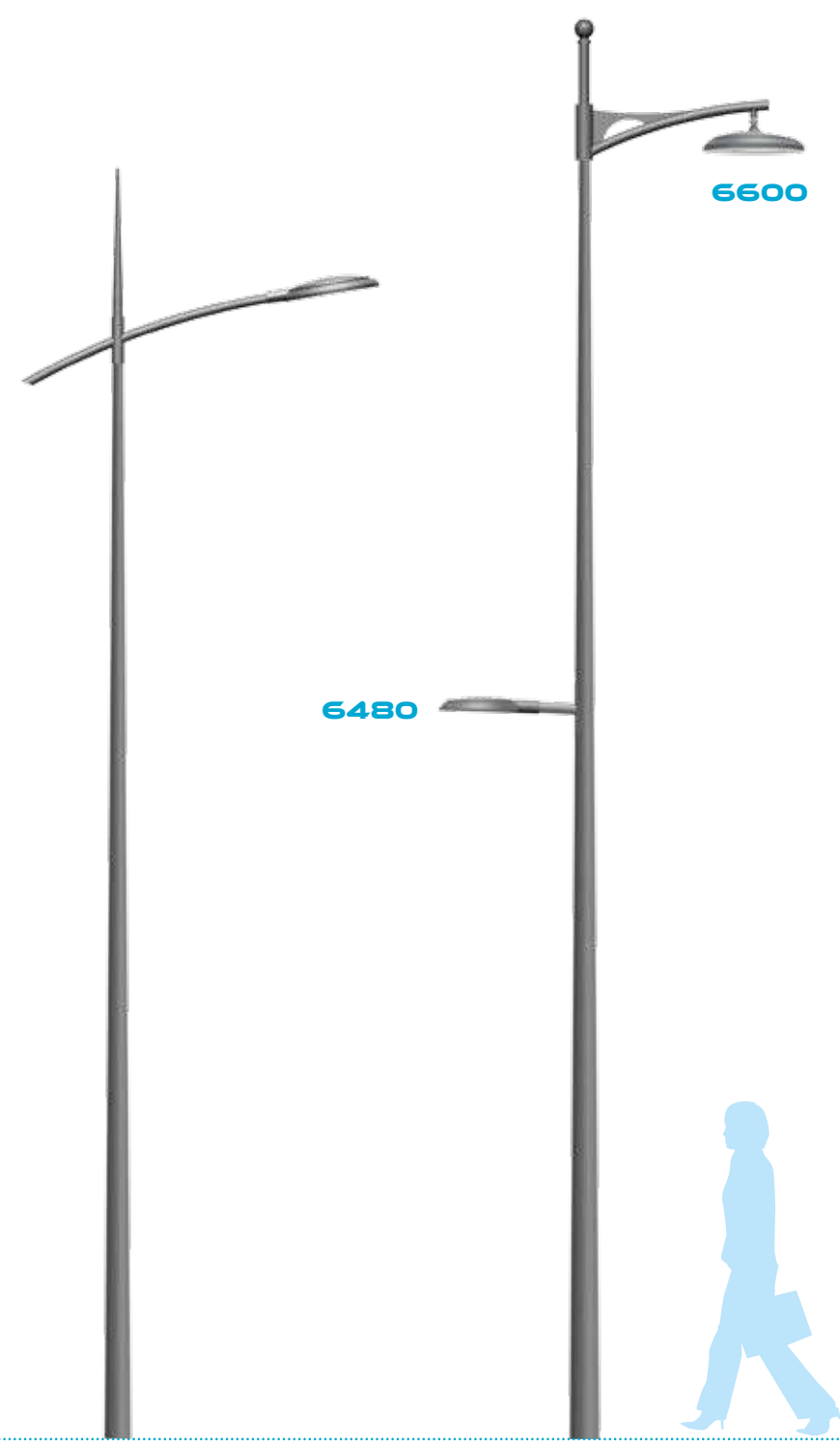

B - LYCIA - cc 600

C - DENISIA - cc 700

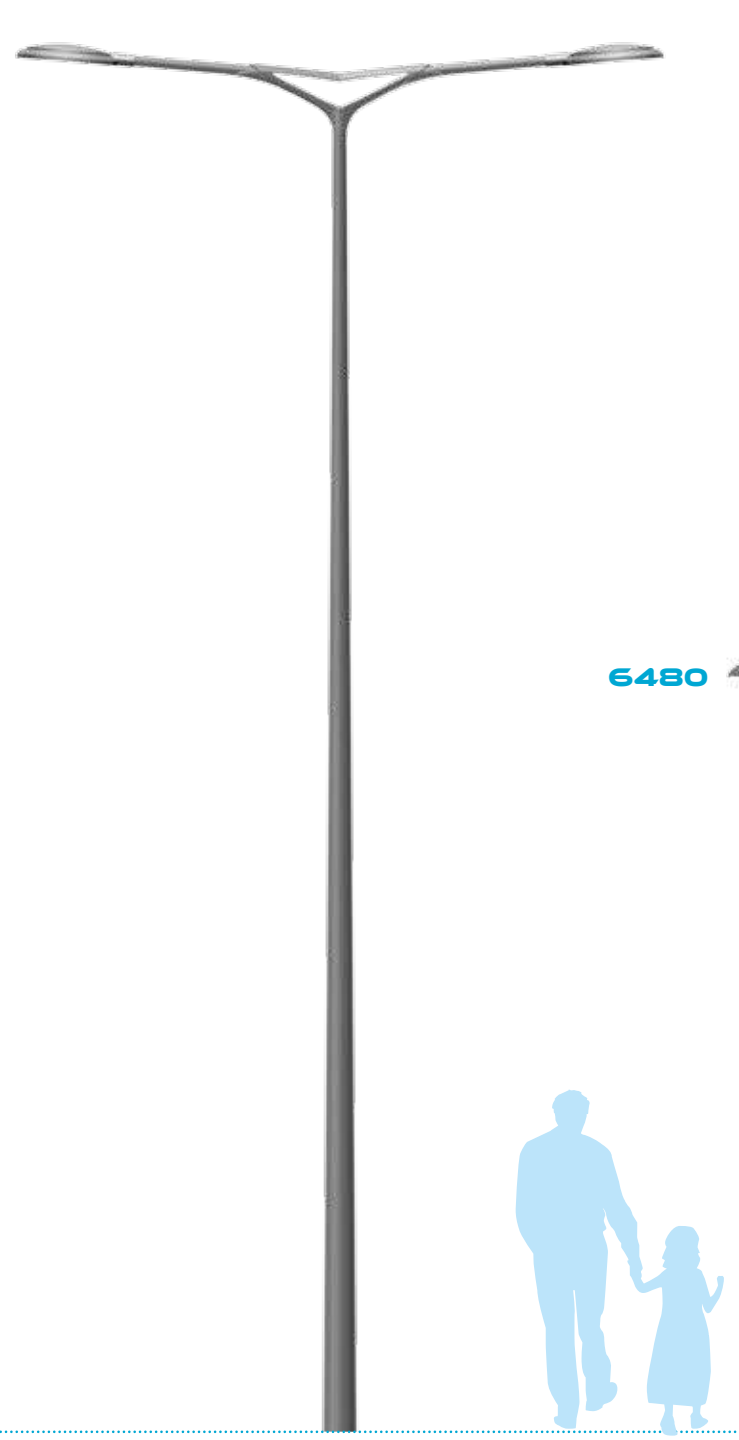

D - KAÏROS - cc 700



E - EXIS - cc 700



F - Curved pole 800





**ATINIA** SLIM

